



1



= 1250  
(-5 °C)

Paslode  
Impulse



3



= 4000

Paslode  
Impulse



2

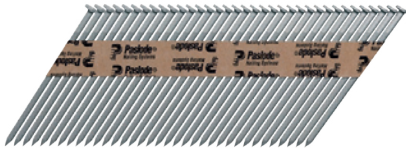

Paslode Impulse

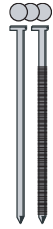

Ø. 2.5 ▶ 3.1 mm  
L 50 ▶ 90 mm  
RoundDrive®

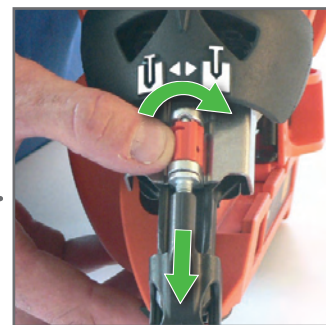
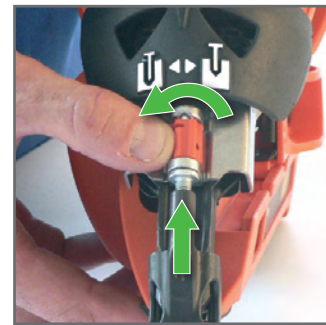
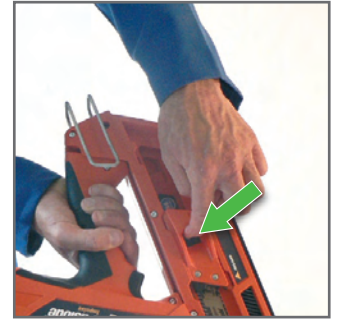
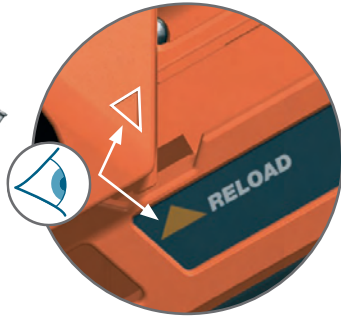

4

- 15 °C ▶ + 49 °C

2-3/s  
1000/h  
4000/day



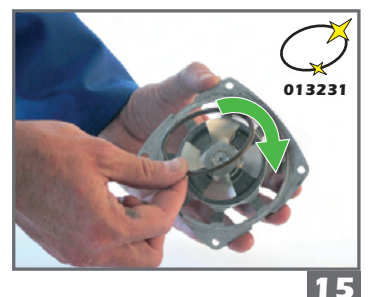
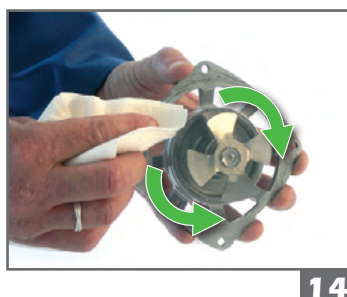
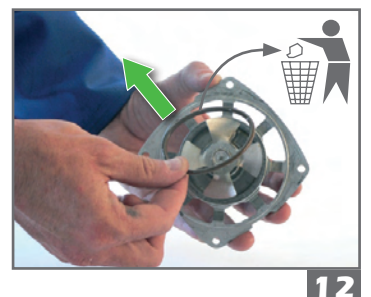
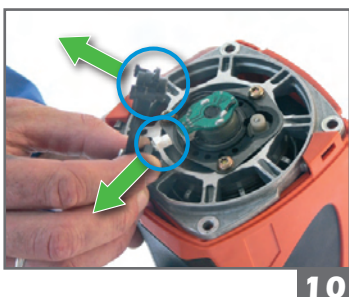
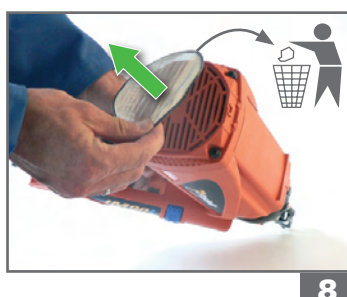
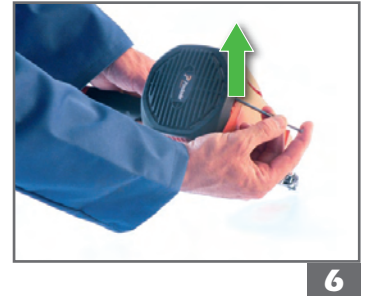
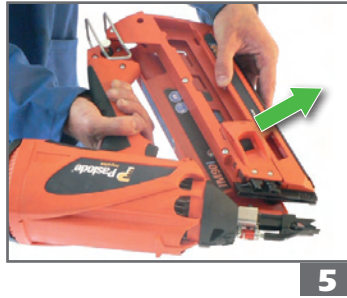
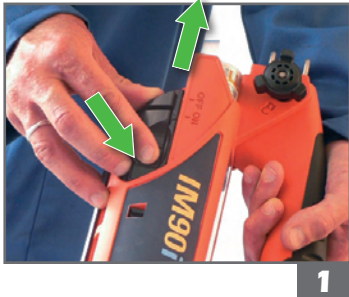

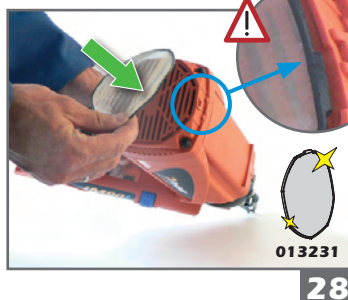
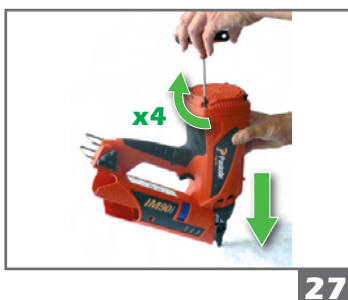
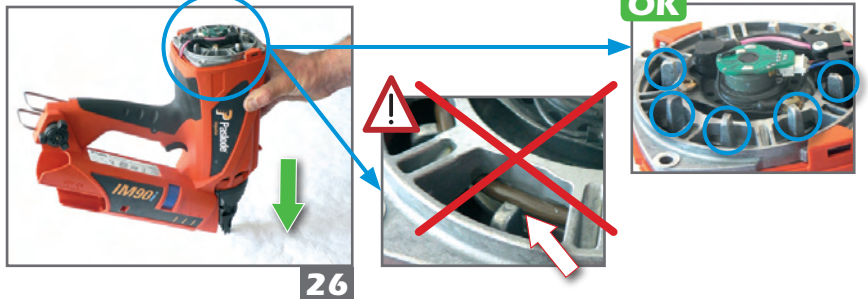
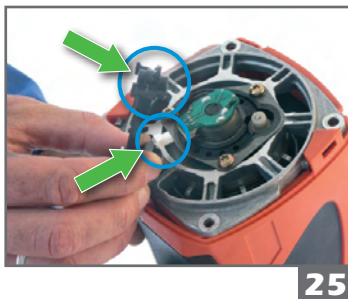
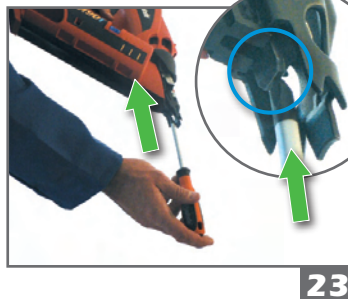
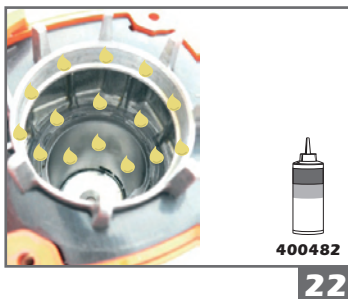
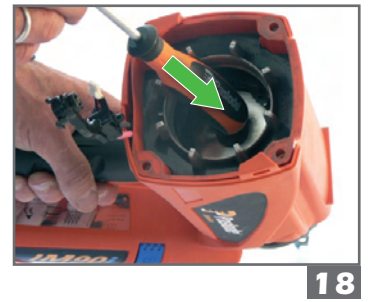
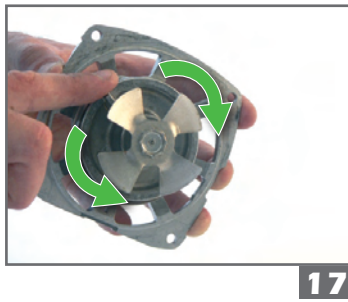
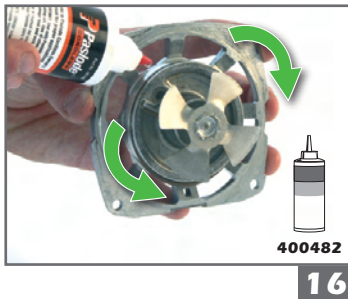

# RESET

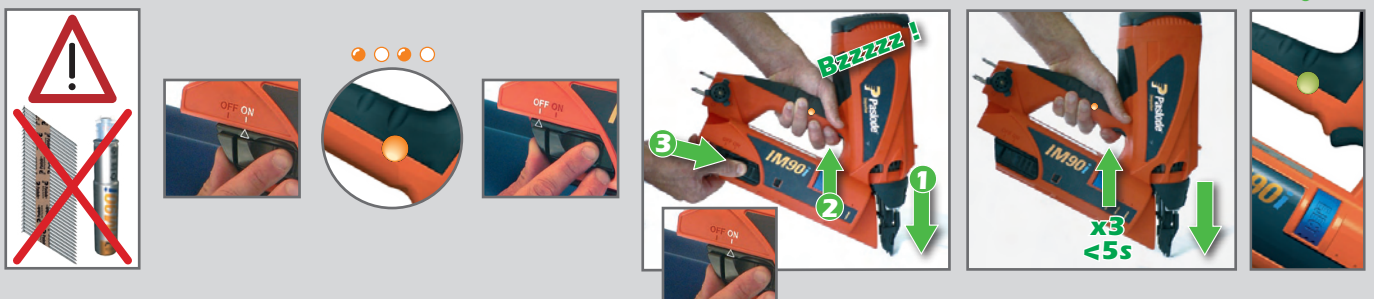

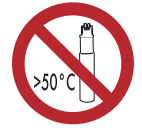
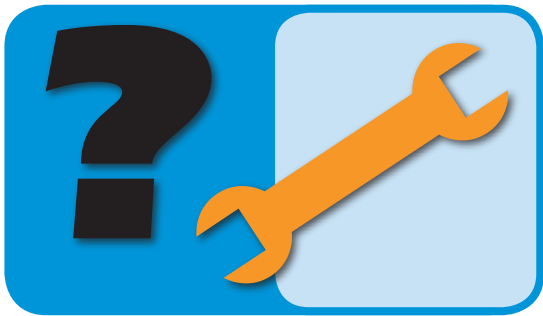

**Bzzzzz !**

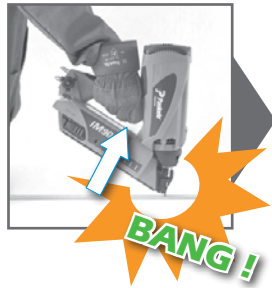
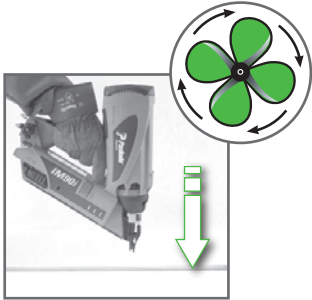

~~**Bzzzzz !**~~

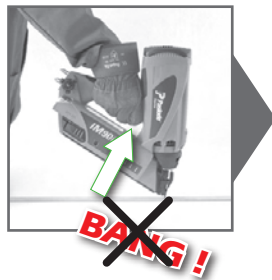
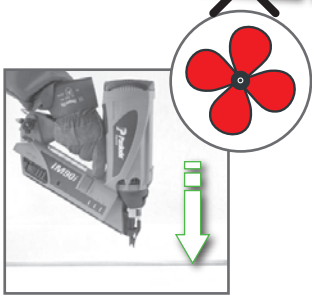

**Bzzzzz !**

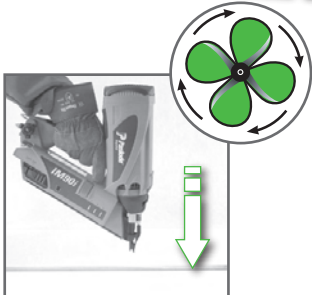

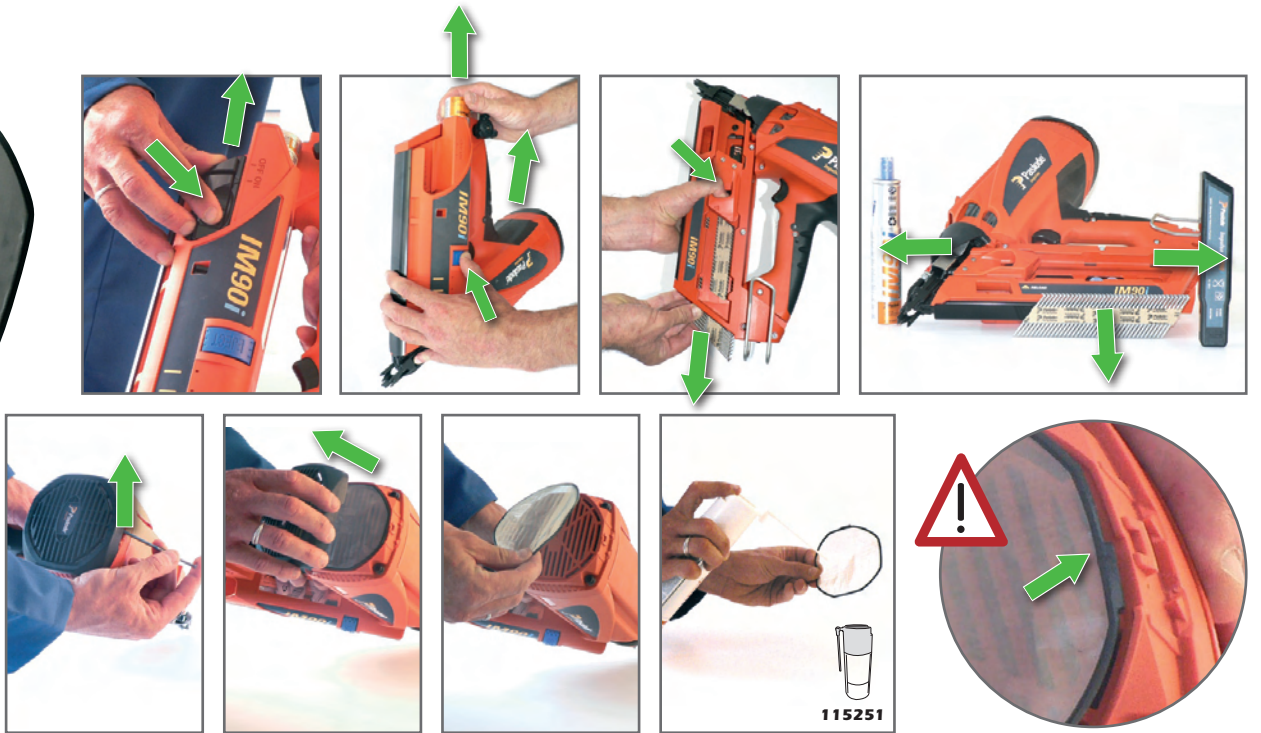

115251



013203-1 07/06

Route de Lyon - BP 104  
 F-26501 Bourg-lès-Valence  
 Cedex - FRANCE

**Paslode**<sup>®</sup>  
 Impulse

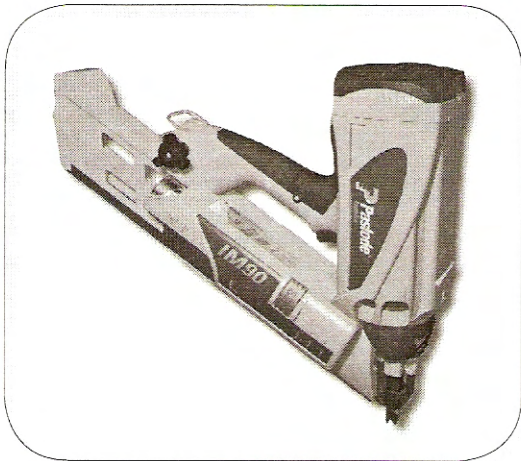

## ***IM90i***

**IMPORTANT!  
DO NOT DESTROY**

Always refer to operating and safety instructions (#013203 & #013207) for detailed information on this tool. It is the customer's responsibility to have all operators and service personnel read and understand this information.

## TOOL SCHEMATIC AND PARTS



# PARTS LEGEND

# IM90i

Part No. 010332 (EU), 010333(UK)

1	336680	1	Retainer ring	52	013730	1	MEFI IM90i
2	013743	1	Cylinder o-ring	53	013768	1	Handle assembly
3	013735	1	Piston assembly	54	013774	1	Right carter label
4	013736	2	Piston ring	55	013773	1	Handle label
5	013778	1	Bumper	56	013734	1	Contact level
6	013758	2	Rubber stop	57	013785	1	Contact plate
7	013779	2	Combustion chamber spring	58	013784	1	Combustion chamber lock bar
8	013752	1	Exhaust baffle	59	013783	1	Trigger spring
9	013753	1	Reed plate	60	013782	1	Trigger
10	013754	1	Reed valve	61	013799	6	Screw Eco-syn Torx 4x25
11	013756	1	Muffler cover	62	013776	1	Handle cover assembly
■ 12	013802	5	Screw swage form 4-11	63	013877	1	Under magazine label
■ 13	013803	3	Screw swage form 4-9	64	013741	1	Shear block
14	013755	1	Muffler	65	013761	1	Follower assembly
15	013751	1	Cylinder assembly	66	013762	1	Follower bottom assembly
16	013737	1	Injection pipe assembly	67	013767	1	Follower spring
17	013738	1	Bracket fuel line	68	013746	1	Battery electrical connection ass.
18	013757	1	Nose	69	401450	1	Battery pad
▲ 19	013796	6	Screw CHC M5-16	70	013764	1	Cover plate magazine (short)
20	013749	1	Combustion Chamber Assembly	71	013765	1	Cover plate magazine (long)
21	013804	4	Screw swage form 4-15	72	013772	1	Left carter label
22	013750	1	Seal	73	013794	1	Magazine label (short)
23	013805	1	Screw taptite 4x8	74	013801	1	Magazine label (long)
24	013781	2	Combustion chamber stop pin	75	013759	1	Magazine assembly (short)
25	013780	2	Combustion chamber stop assembly	76	013760	1	Magazine assembly (long)
26	013742	1	Knob assembly	77	013763	1	Nail channel (short)
27	013744	1	Upper probe assembly	78	013766	1	Nail channel (long)
28	013745	1	Probe	79	013775	1	Nameplate label
29	013791	1	Grill label	80	013771	1	Electrovalve assembly
30	013790	1	Grill assembly	81	013786	1	Ejection bottom assembly
31	013797	4	Screw CHC M5-35	82	013739	1	Electrovalve plug connection
32	013795	4	Cap spacer	83	404702	1	Screw thread forming 6 x 3/8
33	013748	1	Filter	84	013808	1	Wires guide
34	013770	1	Cap	85	013231	1	Maintenance kit (filter + o'ring)
35	013732	1	Spark plug contact assembly				
36	013733	1	Motor assembly				
37	013731	1	Spark plug assembly (901706)				
38	321610	1	Retaining ring				
39	334310	1	Motor mount				
40	321590	1	Motor sleeve				
41	013747	1	Wire assembly				
42	013740	1	Cylinder head				
43	321650	1	Cylinder head O-Ring				
44	321660	1	Fan blade assembly				
45	013769	1	Carter				
46	013787	1	Nose protection				
47	013789	1	Belt hook				
48	013792	1	Magazine ball assembly				
49	013788	1	Cover ball				
50	013798	8	Screw Eco-syn Torx 4x12				
51	013793	1	Magazine knob				

■ Apply Loctite RC-620 (Green)

▲ Apply Loctite 243 (Blue)

→ Denotes Change

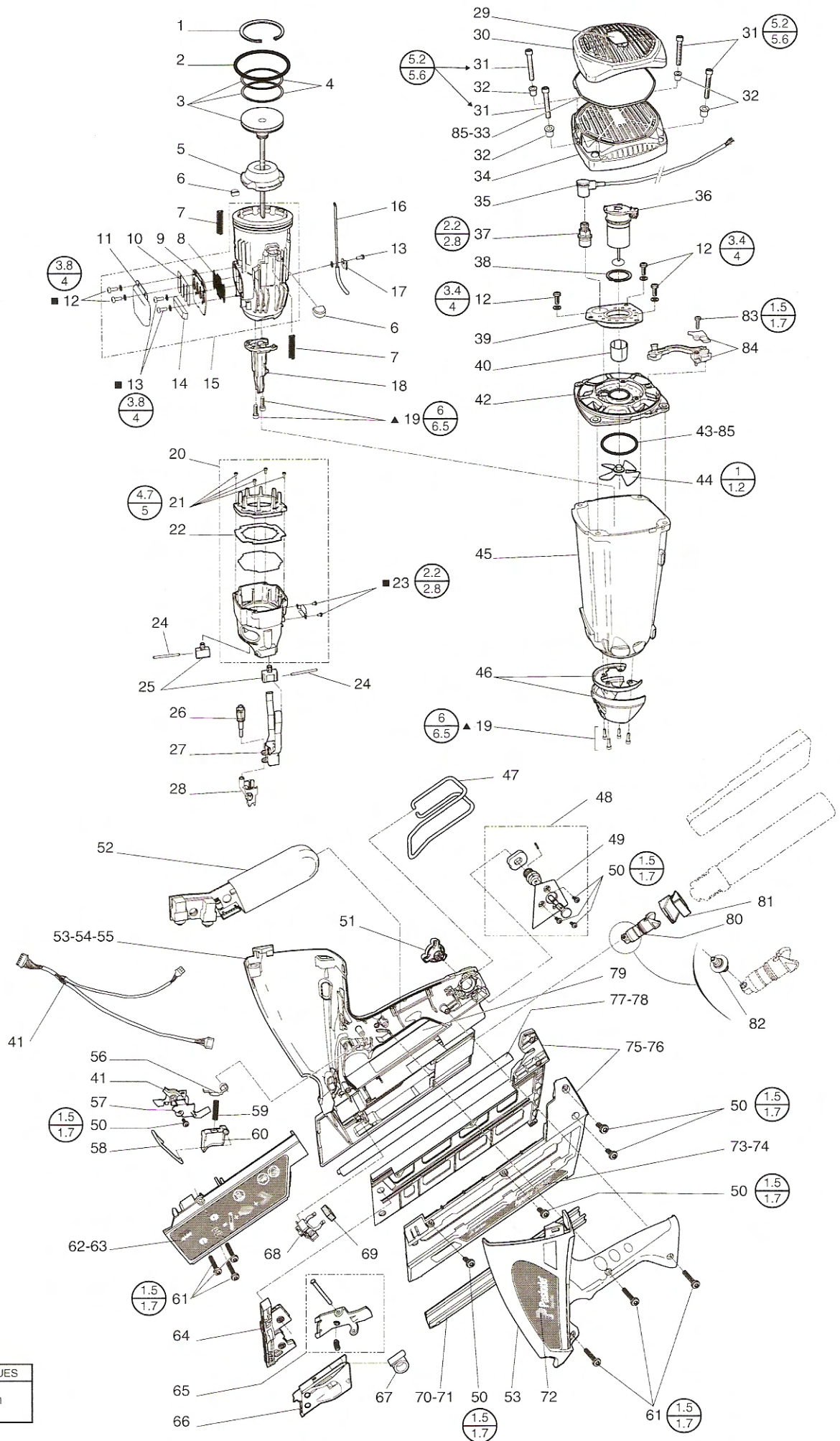

TORQUE VALUES	
MIN	N.m
MAX	

# ACCESSORIES

## Car Adapter

Enables you to re-charge your battery with your vehicle's electrical system.



Part No. 900507

## Battery Cell

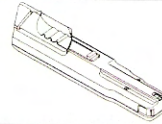

Part No. 013227

## Battery Charger



Part No. 013229

## Transformer

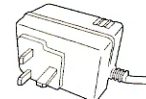
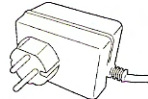

Part No. 210660 (UK)  
Part No. 900505 (EU)

## 4 mm Hex Key



Part No. 013066

## Orange Safety Glasses



Part No. 011117

## Paslode Intensive Tool Cleaner 300 ml

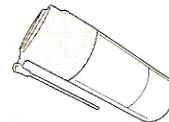

Part No. 115251

## Paslode Impulse Lubricating Oil



Part No. 401482

## Carrying Case Standard

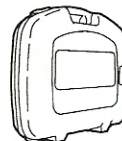

Part No. 013200

## Carrying Case Long Magazine

Part No. 013226

## No-Mar Contact Element

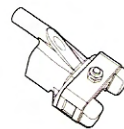

Part No. 013211

## Standard magazine

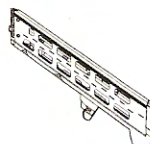

Part No. 013224

## Long Magazine

Part No. 013225

## Cleaning Kit

Contains all the necessary to clean any Impulse tool

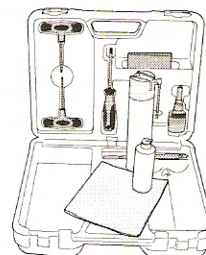

Part No. 013060



An Illinois Tool Works Company  
Route de Lyon - BP 104  
F - 26501 Bourg Les Valence - Cedex France

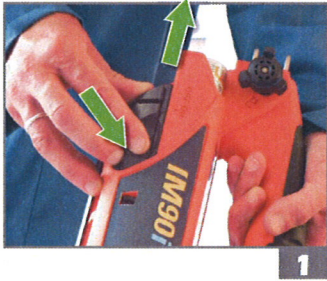
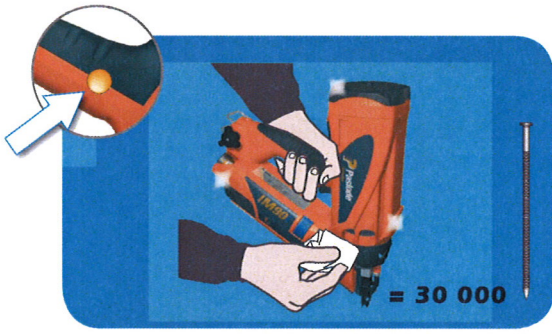

1

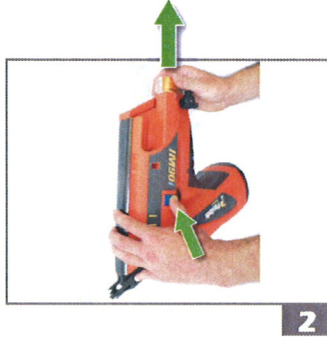

2

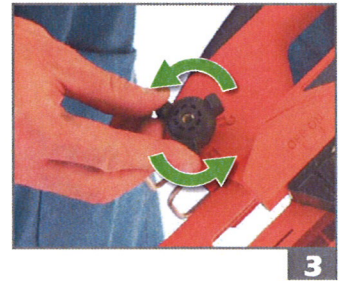

3



4



5

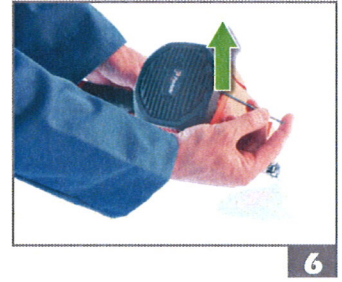

6



7



8



9

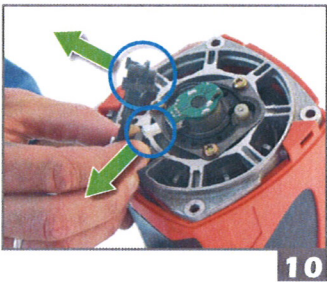

10



11

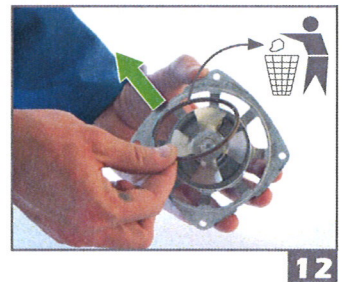

12



13

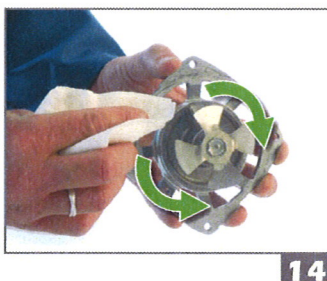

14

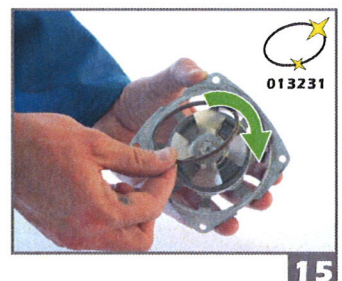

15

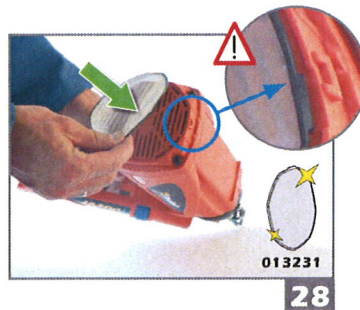
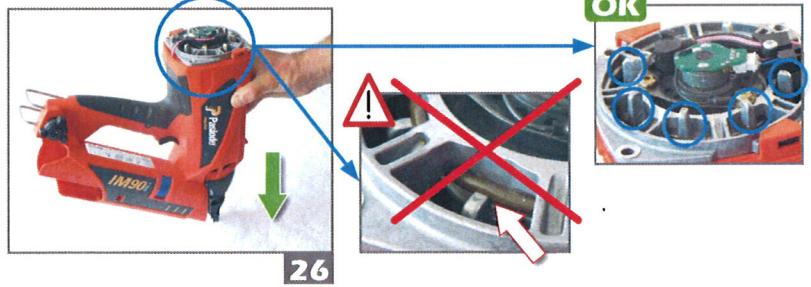
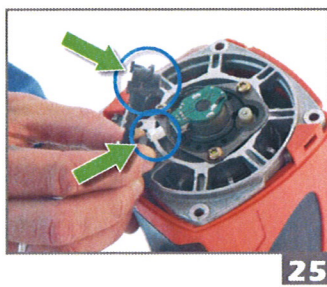
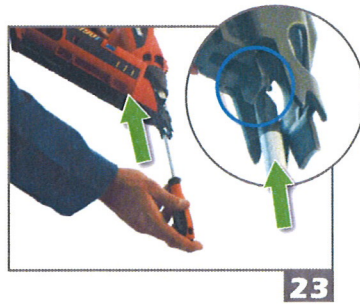
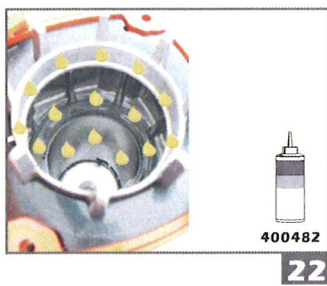
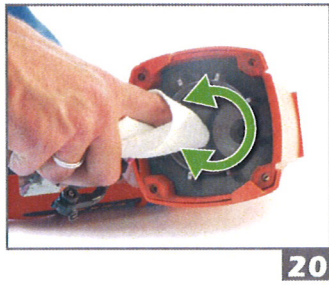
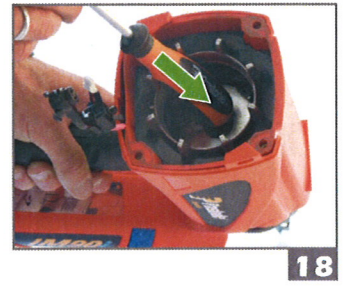
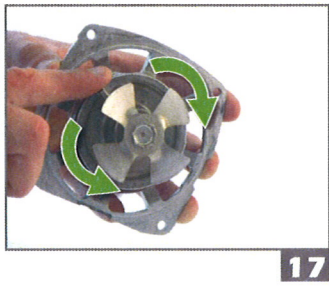
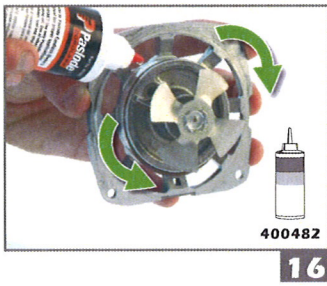

# RESET

